

FLOOR DIFFUSER

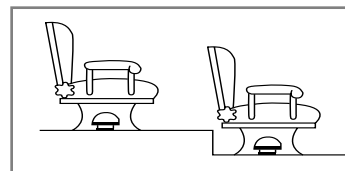

ADVANTAGES

- Strong construction
- Optimal comfort
- Adjustment without disassembly
- Low noise level

in the libraries
Fluid Desk
 Building Engineering Solutions

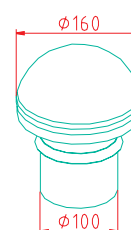

parametric libraries
GRYFIT CAD

FUNCTION

KPS diffusers are designed for installations supplying or exhausting air into or from auditoriums and meeting halls, where the underfloor air distribution system has been designed.

APPLICATION

KPS diffusers are used for air supply into the bottom parts of the room, or to exhaust air from the room if a separate air supply installation is designed. The air is supplied through the diffuser directly into the occupied zone which cause a low air velocity and in a low sound power level of the diffuser.

DESCRIPTION

The diffuser has a very strong construction and can be used in buildings where events for the masses are organized and the risk of vandalism is considerable. The diffuser consists of the following parts:

- airflow deflector made of aluminium sheet, possible to turn in order to adjust or to block the position
- steel covering of deflector
- diffuser casing fitted with an installation depth limiter

The diffuser is coated with standard paint RAL 9005 (black). There is available option of coating the surface with paint in any other RAL colour.

Floor diffuser KPS are available in the following versions:

Standard version: the diffuser with a mounting collar which is used to install the diffuser on the base with the use of three screws.

At request the diffuser can be manufactured with a mounting frame which is used for quick installation / disassembly.

INSTALLATION

The diffusers are installed directly in the raised floor and connected to the ventilation system with the use of the ducts with circular sections, or are installed in the floor where the space underneath is used as over pressure air chamber.

SELECTION

DIMENSIONS

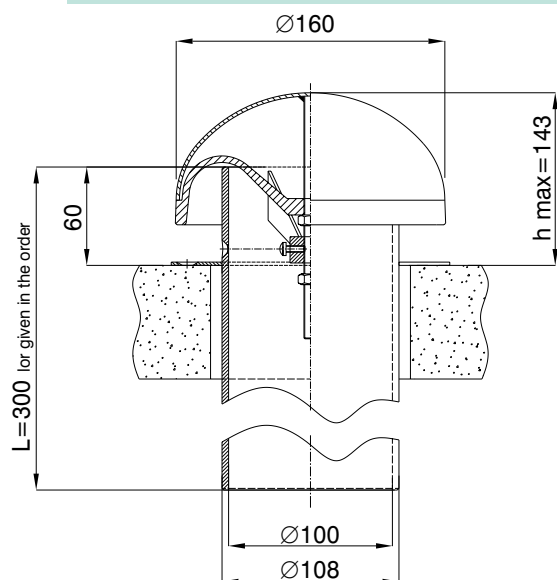

Fixing with the use
of a mounting collar

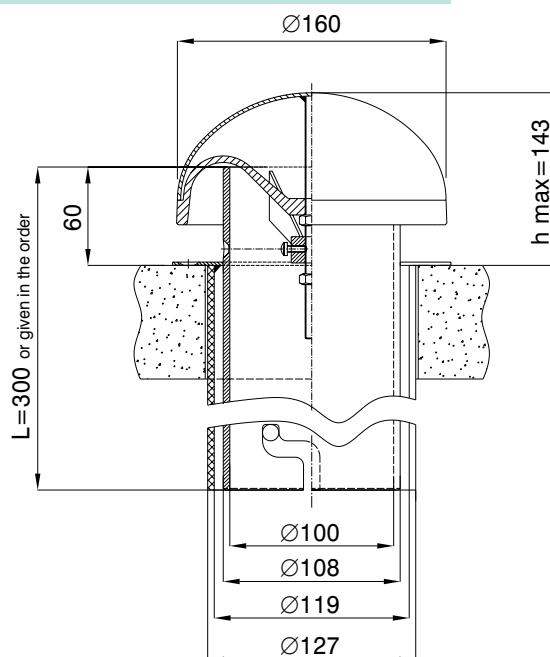

Fixing with the use
of a mounting collar

PRESSURE DROP

Diagram of the pressure drop in airflow function depending on the h height

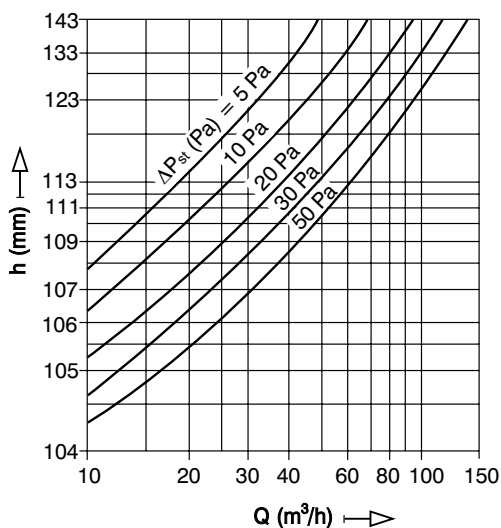
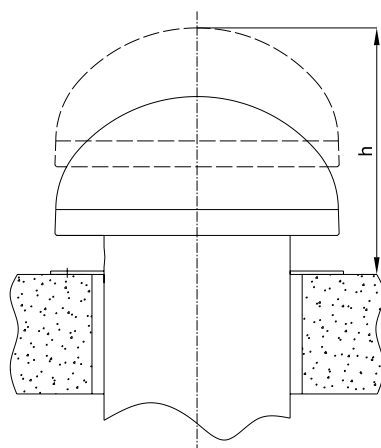

SOUND POWER LEVEL

Airflow [m³/h]	Effective velocity [m/s]	Mid-frequency in octave bands [Hz]						Lw [dB]
		63	125	250	500	1000	2000	
80	2	39	34	33	26	19	-	
60	1,5	36	32	31	24	16	-	
40	1	34	29	28	21	-	-	

ORDER KEY

Diffuser type **KPS** Diffuser length **L=300** + Mounting collar **KM KPS** / Colour of the diffuser **RAL 9005**